

ORDER FORM/PRICE LIST

Revised March 2023

Ordered by/ Quoted to:

Name: _____

Address: _____

City, State ZIP: _____

Phone: _____

Email: _____

Payment information:

CC: _____

Exp.Date: _____ CVV: _____

Billing address: _____

Signature: _____

Date: ____/____/____

Purchase Order no :

Quote no :

Marked for:

Term and Conditions :

KARI strollers are made in Germany and custom built ONLY! Delivery time 4-6 weeks (Subject to change.) Production starts after receipt of payment. **Returns are not accepted.**

*Ships with TForce Freight residential delivery, fully insured, packed on a pallet. TForce Freight will call to setup delivery. Do not accept the shipment if your package is damaged.

KARI STROLLER INCLUDES:



- Padded material (seat & back)
- Adjustable footrest (height & angle)
- Adjustable center of gravity
- Adjustable suspension shock absorbers
- Adjustable push handles with hand brakes
- Adjustable seat angle up to 30 degree
- Powder coated aluminum frame
- 16" rear wheels with drum brakes (quick release)
- 12.5" front jogging wheel
- Canopy with top window
- Separate hand brakes
- Anti-tip support with tip bar



Footrest, adjustable to lower leg length



Seat angle adjustment and suspension



Foldable



Attendant brake with parking function



Seat depth adjustment

ITEM #	DESCRIPTION	USD
<input type="checkbox"/> KK-30002	KARI Size S (Seat depth 10-13" Up to 4'5" tall and 110 lb.)	\$4,995.00
<input type="checkbox"/> KK-30003	KARI Size M (Seat depth 12-17" Up to 5'4" tall and 155 lb.)	\$5,195.00
<input type="checkbox"/> KK-30004	KARI Size L (Seat depth 13-19" Up to 6' tall and 200 lb.)	\$5,695.00

COLOR

Frame Color

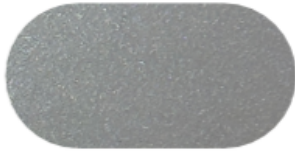

☐ KK-13650
Grey-Metalic



☐ KK-13660
Black-Matt

Fabric Color



☐ KK-13600
Light Grey



☐ KK-13601
Ocean Blue

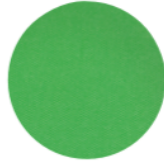

☐ KK-13603
Lime Green

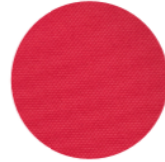

☐ KK-13602
Strawberry Red



☐ KK-13608
Plum Purple



☐ KK-13609
Navy Blue

OPTIONS

ITEM

DESCRIPTION

USD

- | | | | |
|--------------------------|----------|---|----------|
| <input type="checkbox"/> | KK-15401 | KARI Height Adjustable Anti-tipper, left | \$170.00 |
| <input type="checkbox"/> | KK-15402 | KARI Height Adjustable Anti-tipper, right | \$170.00 |
| <input type="checkbox"/> | KK-12810 | KARI Surcharge for Reinforce Seat Angle Adjustment / Suspension (recommended for user weight of 121lbs+) | \$385.00 |
| <input type="checkbox"/> | KK-12850 | KARI Adjustable Backrest Recline Quick Release Lever | \$650.00 |



The back angle is easily adjustable and can be adjusted in the range of 110° - 160° (depending on the seat angle). In combination with the seat tilt, a comfortable position can be created.

- **Requires Anti-tipper on both sides (KK-15401+KK15402)**



Adapter System for Front Wheels

included

Thanks to the adapter system, JOSI-pro can be quickly and easily adapted to the conditions. As an additional advantage, the pack size can be significantly reduced by removing the front wheels. Lifting is easier due to the reduced weight and smaller pack size.

- | | | | |
|--------------------------|----------|--------------------------|----------|
| <input type="checkbox"/> | KK-15300 | KARI Rain Cover | \$650.00 |
| <input type="checkbox"/> | KK-15600 | KARI Mosquito Net | \$650.00 |

REAR & FRONT WHEELS

<input type="checkbox"/>	KK-12916	KARI 16" Rear Wheel (pneumatic)	N/C
<input type="checkbox"/>	KK-12920	KARI 20" Rear Wheel (pneumatic)	\$345.00
<input type="checkbox"/>	JJ-ALLTERRAIN	KARI All Terrain 20" Wheel set complete with 4" tires*	\$625.00
		<i>*Must purchase 20" rear wheels / All terrain will not work with 16" axle plate set up</i>	
<input type="checkbox"/>	JJ-SPOKECOVER	KARI Spoke Cover for 20" wheels	\$175.00



<input type="checkbox"/>	KK-14101	8" Swivel Wheel instead of Jogging Wheel	\$95.00
--------------------------	----------	---	---------

<input type="checkbox"/>	KK-14102	8" Swivel Wheel in addition to Jogging Wheel	\$395.00
--------------------------	----------	---	----------



<input type="checkbox"/>	KK-14300	8" Duo Swivel Wheel (in exchange for single swivel and jogging)	\$475.00
--------------------------	----------	--	----------

<input type="checkbox"/>	KK-14301	8" Duo Swivel Wheel (in addition to Jogging Wheel)	\$695.00
--------------------------	----------	---	----------

NOTE: The Duo Swivel Wheel shortens the front end of the KARI significantly. This can be necessary in narrow spaces. The pivoting Duo Swivel Wheel is best suited for poor and uneven walkways.

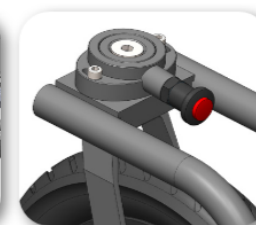

<input type="checkbox"/>	KK-14200	12.5" Pro Front Wheel (adjustable from fixed to swivel) (in exchange for standard jogging wheel)	\$460.00
--------------------------	----------	---	----------

<input type="checkbox"/>	KK-14201	12.5" Pro Front Wheel (adjustable from fixed to swivel) (in addition to standard jogging wheel)	\$675.00
--------------------------	----------	--	----------

NOTE: The 12.5" Pro Front Wheel combines the advantages of the swivel wheel and the fixed front wheel in one. The 12.5" swivel wheel can be locked. This means that uneven pavements or unpaved roads are no problem. As a further advantage, the directional stability can be finely adjusted.

SEATING & POSITIONING



<input type="checkbox"/>	KK-10305	\$260.00	KARI Contoured Hardrest
--------------------------	----------	----------	--------------------------------



<input type="checkbox"/>	KK-10102	\$225.00	KARI Advanced Hardrest
--------------------------	----------	----------	-------------------------------

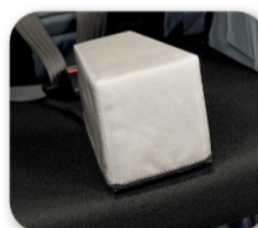

<input type="checkbox"/>	KK-10305	\$90.00	KARI Abduction Wedge
--------------------------	----------	---------	-----------------------------



<input type="checkbox"/>	KK-10301	\$130.00	KARI Comfort Cushion anatomically shaped with memory foam (in exchange for the standard seat cushion)
--------------------------	----------	----------	---

SEATING & POSITIONING

Adjustable Lateral Supports and Back Pad Options



The pad system can be adjusted in both width and mounting position and can be used for a wide variety of positions. The flexible back system adapts to the body.

A back cushion is required when using the pads. For more flexibility and support, the pad system, pro is recommended - see extended range of functions

<input type="checkbox"/> KK-12920	KARI Back Cushion Size 1	Chest Width 6-10"	\$100.00
<input type="checkbox"/> KK-12920	KARI Back Cushion Size 2	Chest Width 8.5-12.5"	\$115.00
<input type="checkbox"/> KK-12920	KARI Back Cushion Size 3	Chest Width 12-16"	\$130.00
<input type="checkbox"/> KK-12920	KARI Thoracic Lateral Pad Size 1	(4x5)	\$300.00
<input type="checkbox"/> KK-12920	KARI Thoracic Lateral Pad Size 2	(5x7)	\$330.00

Harnesses



<input type="checkbox"/> KK-12920	KARI Five-Point Belt, adjustable	\$200.00
-----------------------------------	---	----------

The five-point harness is adjustable in height and length. In addition, the five-point harness has pads which are held in position by Velcro. The adjustable strap length adapts to the size of KARI

KARI 2-Point Pelvic Belt, with magnetic lock (select size below)	\$235.00
---	----------



SIZE	A	B	C	D	Diagram
1	47"	1"	6"	1.75"	
2	55"	1.5"	7"	2"	
3	61"	1.5"	9"	2.75"	

Select Size

<input type="checkbox"/> KK-10771	Size 1	<input type="checkbox"/> KK-10755	Size 2	<input type="checkbox"/> KK-10773	Size 3
-----------------------------------	--------	-----------------------------------	--------	-----------------------------------	--------



KARI Chest Shoulder Belt (select size below)	\$255.00
---	----------

<input type="checkbox"/> KK-10701	Size 1
<input type="checkbox"/> KK-10702	Size 2
<input type="checkbox"/> KK-10703	Size 3
<input type="checkbox"/> KK-10704	Size 4
<input type="checkbox"/> KK-10705	Size 5

SIZE	A	B	C	D	E	F	Diagram
1	4"	7"	12"	5.5"	4.75"	2"	
2	5"	8"	13"	6"	5.5"	2.75"	
3	7.5"	8.5"	16"	8"	7"	3"	
4	8.25"	15"	21"	11"	9.5"	3.5"	
5	9.5"	17"	26"	11"	12.5"	4"	

SEATING & POSITIONING

KARI 2-Point Pelvic Belt, with magnetic lock (select size below)

\$285.00



SIZE	A	B	D	Diagram
1	8.5"	3"	10"	
2	10"	4"	12"	
3	11"	5.5"	14.5"	
4	12"	6"	16.5"	
5	15"	9.5"	18.5"	
6	17"	11"	21"	
7	19"	11"	21"	

☐ KK-10751 Size 1

☐ KK-10752 Size 2

☐ KK-10753 Size 3

☐ KK-10754 Size 4

☐ KK-10755 Size 5

☐ KK-10756 Size 6

☐ KK-10757 Size 7

ACCESSORIES



☐ KK-12500

\$225.00

Extended Canopy

The sun canopy offers protection against both sun and rain. Due to the stable aluminium construction, it additionally protects the side area of the head. There are two zips at the front to attach the sun canopy extension, rain cover or mosquito net (two options can be used at the same time).



☐ KK-15100

\$265.00

Removable Bag

The splash-proof bag is attached to the lower frame structure. It can be used open as a storage net or closed. Due to the mounting on the axle, 12lb max load

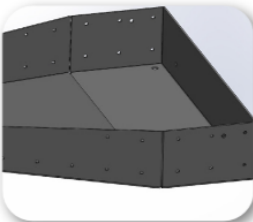
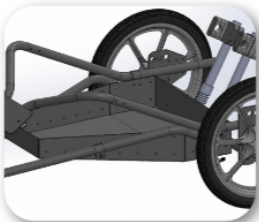

☐ KK-15110

\$705.00

Vent Tray

The platform can support loads of up to 15 kg and is equipped with mounting points. A floor pad and fastening material for webbing up to 40 mm are included in the



☐ KK-15110 **Thigh Lateral Pads - Size 1 (4 x 5)** **\$360.00**

☐ KK-15110 **Thigh Lateral Pads - Size 2 (5 x 7)** **\$375.00**

The pads are available in two different sizes. The pad can be rotated in 90° steps. Due to the two sizes and the infinitely variable adjustment, the pad can be used in all body positions. The mounting positions are possible at seat, leg, upper body and head position.

TECHINAL DATA

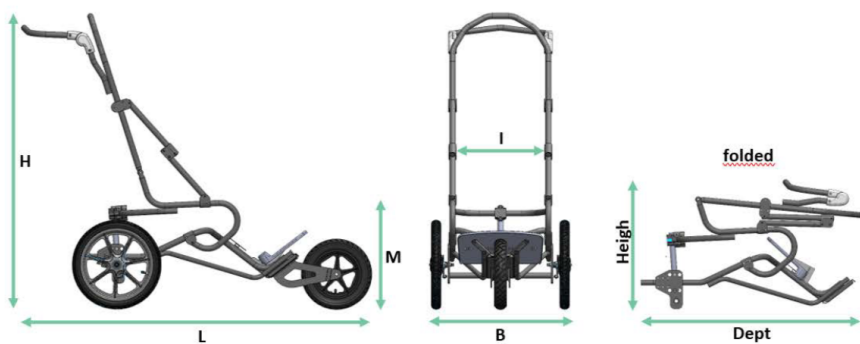

JOSI-pro Article number	Size S JP-30002	Size M JP-30003	Size L JP-30004
Body size	approx. 105-145 cm	approx. 125-165 cm	approx. 150-185 cm
Height: H	128 cm	136 cm	138 cm
Length: L	see next table	see next table	see next table
Track width: B	63 cm	68 cm	73 cm
Inner width/seat width: I	36 cm	42 cm	46 cm
Seat height: M (incl. cushion)	57 cm	57 cm	59 cm
Seat depth	25 - 40 cm	30 - 45 cm	35 - 50 cm
Lower leg length	up to 36 cm	up to 42 cm	up to 47 cm
Total back height	80 cm	90 cm	95 cm
Packing dimensions: WTH	55 x 102 x 59 cm	60 x 105 x 62 cm	65 x 110 x 67 cm
Payload / user weight	max. 50 kg	max. 70 kg	max. 90 kg
Additional payload bag	max. 5 kg	max. 5 kg	max. 5 kg
Additional payload platform med. devices	max. 15 kg	max. 15 kg	max. 15 kg
Weight (frame with covering)	16,5 kg	18 kg	20 kg
Rear wheels, pneum. tyres	16" / 20"	16" / 20"	16" / 20"
Air pressure rear wheels	2.0 bar (16" & 20")	2.0 bar (16" & 20")	2.0 bar (16" & 20")
Front wheels, pneum. tyres	see next table	see next table	see next table
Wheel camber	0°	0°	0°
Seat angle	approx. 10° - 30°	approx. 10° - 30°	approx. 10° - 30°
Back angle (optional)	approx. 110° - 160°	approx. 110° - 160°	approx. 110° - 160°

	Size S	Size M	Size L	
12.5" rigid front wheel:				
Length in basic position, depending on adjustment push handle: L1 - L2 Air pressure	132-154 cm 1.8 bar	140-164 cm 1.8 bar	147-182 cm 1.8 bar	
8" swivel wheel:				
Length in basic position, depending on adjustment push handle: L1 - L2 Air pressure	116-138 cm 2.5 bar	124-152 cm 2.5 bar	132-167 cm 2.5 bar	
8" swivel wheel duo:				
Length in basic position, depending on adjustment push handle: L1 - L2 Air pressure	107-128 cm 2.5 bar	115-142 cm 2.5 bar	122-158 cm 2.5 bar	
12.5" Front Wheel Pro:				
Length in basic position, depending on adjustment push handle: L1 - L2 Air pressure	135-157 cm 1.8 bar	142-170 cm 1.8 bar	161-197 cm 1.8 bar	



Imported and distributed into the USA & Canada by
Mobility & Access, Inc.
 1003 International Drive, Oakdale, PA 15071
 Phone (724) 695-1590 Fax (724) 695-1593
 TAX ID#: 20-8037554

KARI Stroller

info@mobilityaccess.com
 www.mobilityaccess.com
 @mobilityandaccess